

*“Build a Sanctuary for me,  
and I will dwell amongst them.”*

Exodus 25:8



CONGREGATION  
BethShalom

## Mission Statement

---

*Congregation Beth Shalom, an egalitarian Conservative Synagogue, welcomes individuals from diverse backgrounds to strengthen connections with God, Torah and the Jewish people through communal commitment to prayer, study and acts of loving kindness.*

---



**Congregation Beth Shalom** has been a leader in the greater Kansas City Jewish community since 1878. The congregation traces its history back to some of Kansas City's earliest Jewish settlers, who formed the Orthodox congregation Keneseth Israel in the late 1800s. Keneseth Israel built its first synagogue building in 1902 at 1425 Locust Street. Shortly thereafter, Beth Shalom was formed in 1915.

Beth Shalom and Keneseth Israel merged in 1924, and in 1927 the congregation moved to a new synagogue building at 3400 Paseo Boulevard. It remained there until the early 1960s, when a religious school building was built at 95th and Wornall followed by a sanctuary in 1971.





**Our synagogue** is currently located in south Overland Park, Kansas, at 143rd and Lamar. In many ways, the move to our current site mirrors the move made in the late 1950s from 3400 Paseo Boulevard west to the Wornall campus. Our Lamar campus has been open since 2006, but it wasn't designed to host all of the congregation's activities. Its intended purpose was to house the educational programs while members would continue to worship in the sanctuary on 95th and Wornall Road. The Wornall building was closed due to its aging structure which resulted in the need to utilize the Lamar multi-purpose room both for worship and social events.

Our synagogue has relocated several times in order to accommodate our members' shifting demographics and their migration south into suburban Johnson County, Kansas. These congregational moves have each been completed in stages – first the educational facilities and then the sanctuary.

## Project Description

Beth Shalom has gone for nearly a decade without a sacred space for worship. When we came to our Lamar campus, our first priority was to create a space for our children to learn: classrooms for our Polsky Religious School and our Rose Early Childhood Education Center. We were able to use the Goldsmith Hall multi-purpose space for prayer and community gathering.

The time has come for our congregation to construct a sanctuary so members can worship together in their home. This new sanctuary will create inspiring space to pray together on the High Holidays, sing together on Shabbat mornings and dance together on Simchat Torah. We will celebrate together new babies, teens reaching the age of Bar and Bat mitzvah, couples uniting through marriage and milestone anniversaries.

The purpose of this project is to create a beautiful and inspiring space that will enhance our Jewish spiritual experiences.

*The purpose of this project is to create a beautiful, inspiring and communal space that will uplift our Jewish living together.*





**We considered many factors** in determining the size and scope of our sanctuary construction project. Should we build to host Shabbat services, Bar and Bat Mitzvah celebrations and daily services? Or should we build a sanctuary large enough to host High Holiday services which often attract the entire congregation and may result in standing room only, but only last three days a year? The uniqueness of this design is that it is flexible. The sanctuary creates an intimate and meaningful setting whether we are having a Shabbat service with regulars, a Bar or Bat Mitzvah celebration, the High Holidays or a wedding of any size.



#### New Additions

1. Drop-Off
2. Entry Vestibule
3. Lobby
4. Sanctuary
5. Chapel (76-seat Chapel, 108-seat Sanctuary extension)
6. Coats
7. Meat Kitchen
8. Trash/Recycling and Vehicle Storage
9. Sukkah and Memorial Garden
10. Sukkah and Trash Enclosure Wall with Landscape
11. Playground Wall with Landscape
12. Yahrzeit Wall
13. Men's Room

#### Renovation

14. Expanded Women's Room
15. Reconfigured Milk Kitchen
16. Reconfigured Receiving
17. New Serving Corridor
18. Goldsmith Hall
19. Breakfast Room
20. Reconfigured Meeting Room
21. Reconfigured Drop-Off

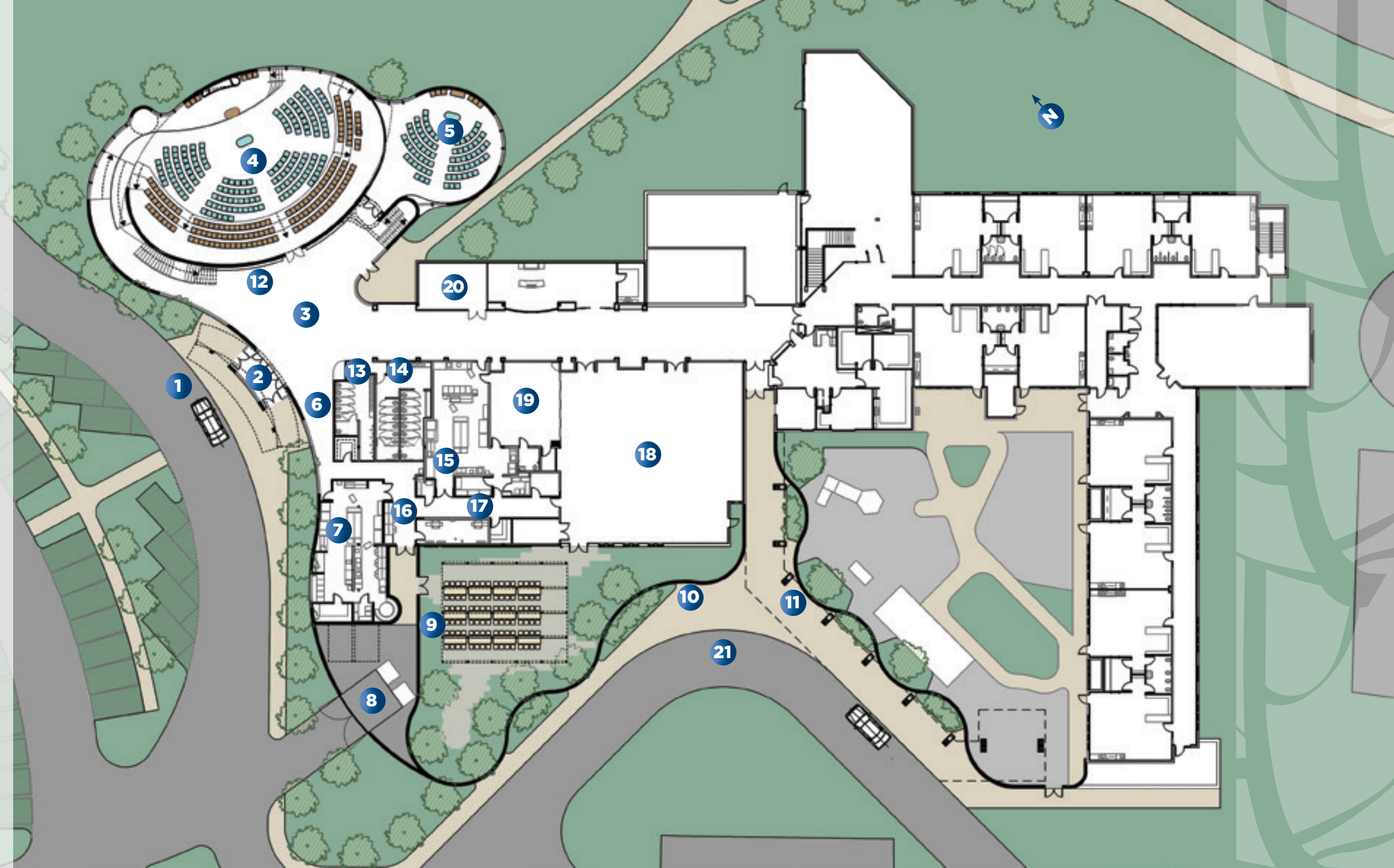



## Following an extensive planning process,

we chose nationally known Preston “Scott” Cohen as our lead architect. Scott is the Gerald M. McCue Professor of Architecture at the Harvard University Graduate School of Design, whose work has been widely recognized. He was chosen “because of his ability to listen to the soul of the community, find inspiration from our Jewish past and understand the need for flexibility in a modern synagogue.” Scott will also be working with Kansas City’s own BNIM, the firm that designed The Bloch Building of the Nelson-Atkins Museum of Art and The Kauffman Center for the Performing Arts.

*The Torah teaches that the human being is meant to be a steward of planet Earth, “to work it and to protect it.”*

Genesis 2:15

**The new sanctuary** will have seating close to the bimah and the reader’s table and everyone will be close to one another praying. The space will have inspiration from Jerusalem, the spiritual heart of the Jewish people. The interior will have wood tone accents reminiscent of the Eastern European wood synagogues from the towns of Beth Shalom’s original founders. The windows open to the natural views of our native Kansas. Plans include using natural light and sustainable materials which reflect the Jewish values of conservation.

**According to the Talmud**, the responsibility of building a synagogue rests collectively on all members of a Jewish community.

*The funding for building a synagogue should come from the community and should be collected on the basis of each individual’s financial means. If the community can’t afford to purchase or build a synagogue, they must rent a space for prayer. Conversely, if they can afford to buy or build a synagogue, they should not suffice with renting.*

Code of Jewish Law, *ibid.*,150:1;  
Mishnah Berurah, *ibid.*

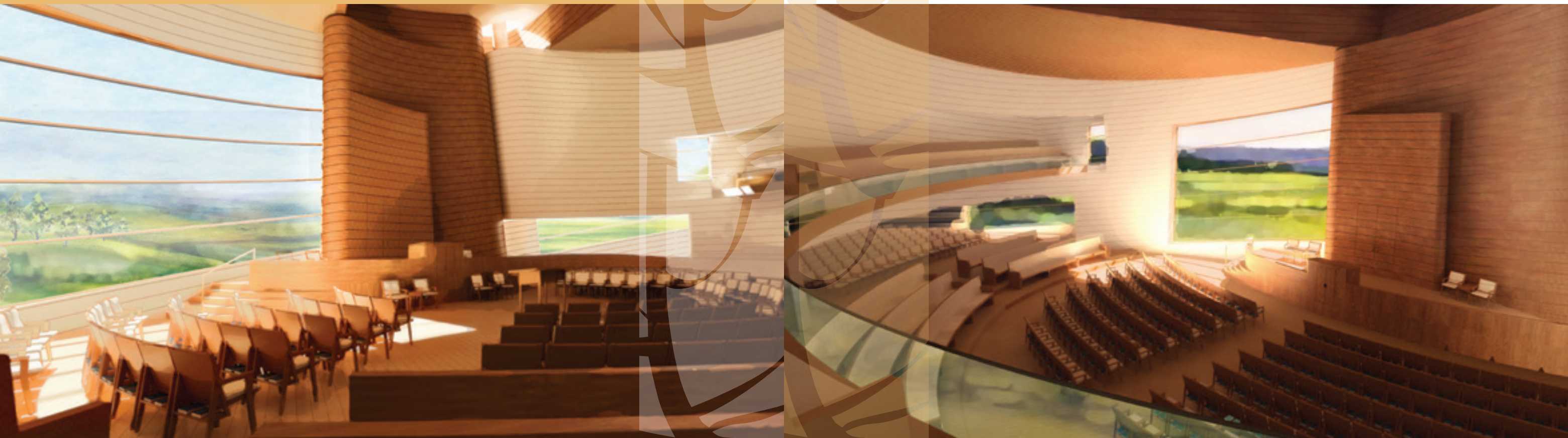



*We are counting  
on 100%  
participation  
from our  
community.*

## Ways to Get Involved

There are many ways to get involved to help ensure a successful campaign. Here are ways in which you can help:

- ▲ **JOIN THE CAMPAIGN COMMITTEE:** This is one of the rare opportunities to be on a synagogue committee which has a limited timeframe. Our committee consists of lay leaders from the congregation who can serve as ambassadors of the campaign. This group meets semi-regularly to make important decisions about the campaign and involve the entire community in this fundraising initiative by soliciting gifts. The time commitment is finite and is defined by the volunteer. Plus, the impact of the committee will be visible for generations and this does not go without recognition.
- ▲ **HELP SPREAD THE WORD:** We are counting on 100% participation from our community. Thus, it is important that the entire congregation knows about the campaign and provides support. Helping to spread the word includes calling and emailing congregants to share the plans and hear feedback on this project.
- ▲ **HOST A CAMPAIGN EVENT:** The campaign, in addition to being a fundraising effort, is a community building effort. Therefore, it is key that our full congregation learns and is inspired by the plans for the future of Congregation Beth Shalom. Hosting an event will help provide a forum for community members to ask questions and learn about the plans directly from the campaign leadership.

### Timeline:

The project will begin in 2020 and construction will be complete by 2022.

### Budget:

Our campaign goal is to raise \$15 million for this project.

### Make a Gift

This is a once-in-a-lifetime opportunity to make a major impact on the future of our synagogue and our community. Gifts of all sizes are welcome as are pledges over a number of years or planned gifts.



CONGREGATION  
**BethShalom**

14200 Lamar Ave, Overland Park, KS 66223

Phone: (913) 647-7279